

PRODUCT # : CL-523-SI

• Directional Lights

• Machined Aluminum

Fixture Specifications:

Housing: Corrosion resistant machined aluminum.

Finish: **SI- Silver.** Smooth surface (no texture) polyester UV powder coated. *Also available in BK-Black, & BZ- Bronze*
Lens: Clear, tempered, and heat resistant glass.

Socket: Top grade fixed ceramic bi-pin socket, with lamp retention clip to securely hold lamp in place.

Lamp: 12V, MR-16 LED
Available in 3.5W, 5W, 6W or without lamp.
See lamp guide, below for more information.

Wiring: Fixture is prewired with a 3ft 18-2 SPT1-W direct burial cord and underground connectors.

Gasket: Silicone double gasket for water tight sealing.

Knuckle: Adjustable machined aluminum knuckle with Stainless Steel Philips screw and ½" NPT threaded male hub

Mounting Spike: 8½" slotted black ABS spike with ½" NPT threaded female hub.

Electrical Notes: A remote 12V transformer is required. Options are available from Corona Lighting.
Voltage range for LED lamps are 9V-17V.
Proper grease/lubricant is suggested on threaded parts during installation process.

Warranty: Ten (10) year warranty on fixture housing against manufacturer's defects.

3.5W, 5W & 6W

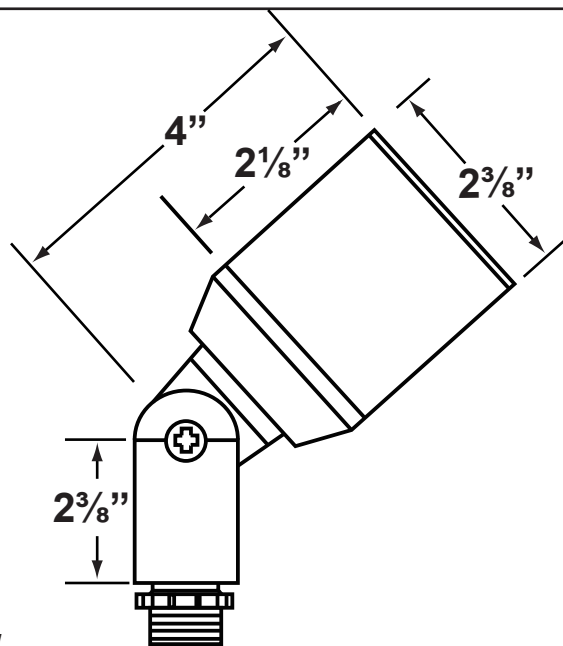

AVAILABLE LED LAMPS (Corona LED lamps have a five (5) year limited warranty against manufacturer's defects)

LAMP NUMBER	WATTS	BEAM		COLOR & TEMP.	RATED HOURS	HALOGEN EQUIVALENT
		SPREAD	LUMEN			
L-ED16-3W-SP	3.5	15° Spot	270	2700K	50,000	25 Watt
L-ED16-3W-FL	3.5	45° Flood	270	2700K	50,000	25 Watt
L-ED16-3W-WF	3.5	60° Wide Flood	270	2700K	50,000	25 Watt
L-ED16-5W-SP	5	15° Spot	350	2700K	50,000	40 Watt
L-ED16-5W-FL	5	45° Flood	350	2700K	50,000	40 Watt
L-ED16-5W-WF	5	60° Wide Flood	350	2700K	50,000	40 Watt
L-ED16-COB5W-SP	5	15° Spot	450/470	2700K/3000K	50,000	50 Watt
L-ED16-COB5W-FL	5	38° Flood	450/470	2700K/3000K	50,000	50 Watt
L-ED16-COB5W-WF	5	60° Wide Flood	450/470	2700K/3000K	50,000	50 Watt
L-ED16-6W-SP	6	15° Spot	600	2700K/3000K	50,000	75 Watt
L-ED16-6W-FL	6	38° Flood	600	2700K/3000K	50,000	75 Watt
L-ED16-6W-WF	6	60° Wide Flood	600	2700K/3000K	50,000	75 Watt

■ Single color MR-16 LED available in AMBER, BLUE, GREEN, PURPLE, RED and VIOLET

JOB INFORMATION

TYPE:

DATE:

JOB NAME & ADDRESS:

PRODUCT #:

TOTAL QUANTITY:

LAMP TYPE & WATTAGE:

TRANSFORMER:

CONTRACTOR:

SPECIFIER:

• When ordering LED lamp with a fixture your part number should follow the format below:

• CL - product # - lamp - wattage - lamp angle

CL - 523-SI - L-ED16 - 5W - FL

Example: CL-523-SI-L-ED16-5W-FL

• Corona Lighting reserves the right to make any change and/or improvement to the design and construction of this fixture without further notification.

PRODUCT # : CL-523-SI

•Directional Lights

•Machined Aluminum

Cable Connectors

- CX-854 Direct Burial Silicone Filled Wire Nut, **Tan**
CX-LOC Quick-locking gel filled wire connector
Two / Pack, **Tan**

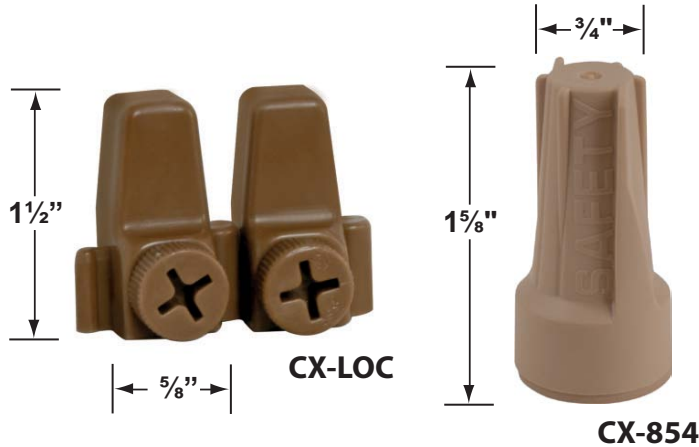

Mounting Posts For Sign Light & Path Light Applications

- CX-678-SI 24" Aluminum Single Head Post, **Silver**
CX-679-SI 24" Aluminum Double Head Post, **Silver**
CX-690-SI 18" Aluminum Single Head Post, **Silver**
CX-693-SI 18" Aluminum Double Head Post, **Silver**



•CX-718 (Mounting Canopies pg 2) is required for sign light installation.

Mounting Canopies

- CX-701-BK Aluminum Mini 3 Hole Round Canopy, 1/2 NPT, **Black**
CX-702-BK Aluminum Rectangular Canopy, 1/2 NPT, **Black**
CX-709-SI Aluminum Raised Canopy, 1/2" NPT, **Silver**
CX-718B-SI 5" Brass Canopy, 3-Hole 1/2" NPT, **Silver Plated**
CX-721 Aluminum Tree mount Canopy with 15" Rubber Strap stretches to 22"
Finishes: **BK**- Black, **BZ**- Bronze
CX-722 Aluminum Tree mount Canopy with 22" Rubber Strap stretches to 33"
Finishes: **BK**- Black, **BZ**- Bronze
CX-723 Aluminum Tree mount Canopy with 31" Rubber Strap stretches to 45"
Finishes: **BK**- Black, **BZ**- Bronze



ACCESSORIES SHEET

PRODUCT # : CL-523-SI

• Directional Lights

• Machined Aluminum

Mounting Pedestals

CX-603-BK 3" PVC Mounting Pedestal, 1/2" NPT Female Brass Hub on top, **Black**

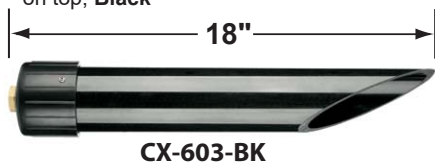

CX-603-BK

Ground Spikes

CX-644-BK 8 1/2" x 1/2" Slotted Plastic Spike, **Black** (Included with fixture)

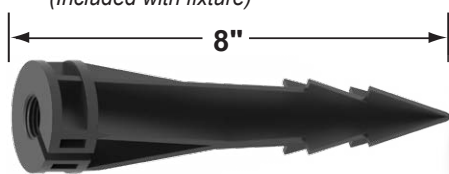

CX-644-BK

CX-646-BR 8" ABS Spike, 1/2" NPT, **Natural Brass**

CX-647-BK 10.5" Heavy Duty ABS Spike, 1/2" NPT, **Black**

Special Lenses & Honeycomb Louvers

CX-238 MR-16 Snap-on holder, **Silver Plated**

CX-239 MR-16 honeycomb louver, **Black**

CX-240-AM MR-16 color lens, **Amber**

CX-240-BL MR-16 color lens, **Blue**

CX-240-GR MR-16 color lens, **Green**

CX-240-RD MR-16 color lens, **Red**

CX-240-YL MR-16 color lens, **Yellow**

CX-241 MR-16 lens, **Linear Spread**

CX-242 MR-16 lens, **Frosted**

CX-243 MR-16 lens, **Prismatic**

For MR-16 Lenses and Louvers, you will need the CX-238



Transformers

T-LTF60 60W, 12V, Compact Mini Transformer
T-LT75 75W, 12 and 15V, Single Circuit Transformer w/ Integrated Mechanical Timer.
T-LT150 150W, 12-15V, Single Circuit Transformer.
T-LT300 300W, 12-15V, Single Circuit Transformer.
T-LT600 600W, 12-15V, Dual Circuit Transformer.
T-LT900 900W, 12-22V, Triple Circuit Transformer.
T-FIDT Field Installed Plug-in Digital Timer.
T-FIT Field Installed Plug-in Mechanical Timer.
T-TR-FIP Field Installed Plug-in Photocell



T-LT75

T-LT150



Dimmers

CX-DIM-100 100W, Low Voltage Dimmer Switch. Use with T-LT Series Transformers, **Black**

CX-DIM-100

