

SPECIFICATION SHEET

PRODUCT # : CL-353

• Step Light

• Aluminum

Fixture Specifications:

Housing: Diecast aluminum
Finish: Polyester UV powder coated available in, **BK**- Black
Lens: Frosted, tempered and heat resistant glass lens.
Socket: Top grade fixed T5 wedge socket
Lamp: 12V T3, 35W max.
Available with no lamp or in LED (2W or 2.5W).
See the Lamp Guide below for more information.
Wiring: Fixture prewired with a 3ft direct burial cord. Wire connector sold separately. Silicone filled wire nut (**CX-854**) are available from Corona Lighting.

Mounting: Surface mounted, mounting plate is included.
Outdoor use only.
Gasket: Silicone "O" ring seals faceplate to housing providing weather tight protection.
Electrical Notes: A remote 12V transformer is required. Options are available from Corona Lighting.
Voltage ranges for LED lamps is 11-12.5V(**BZ**) and 8-21V (**BK/WH**).
Warranty: One year warranty providing protection against manufacturer's defects.

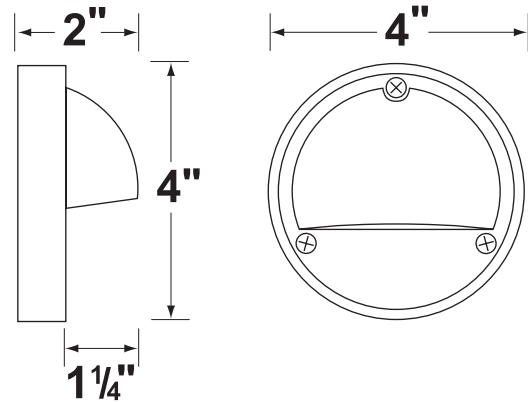

1.5W(BZ)
2W & 2.5W(BK/WH)

AVAILABLE LED LAMPS (Corona LED lamps have a five (5) year limited warranty against manufacturer's defects)

FOR BZ		BEAM		COLOR & TEMP.	RATED HOURS	HALOGEN EQUIVALENT
LAMP NUMBER	WATTS	SPREAD	LUMEN			
L-EDT5-1.5W	1.5	180°	120	2700K	12,000	10 Watt
FOR BK & WH		SPREAD	LUMEN	COLOR & TEMP.	RATED HOURS	HALOGEN EQUIVALENT
LAMP NUMBER	WATTS					
L-EDT3-2W	2	360°	200	2700K	25,000	20 Watt
L-EDT3-2.5W	2.5	180°	240	2700K	25,000	35 Watt
L-EDT3-2W-3K	2	360°	210	3000K	25,000	20 Watt
L-EDT3-2.5W-3K	2.5	180°	250	3000K	25,000	35 Watt
L-EDT3-AM*	2	360°	170	2000K	25,000	20 Watt

* AM- Amber color

For more additional Lamps, and accessories visit Coronalighting.com

JOB INFORMATION

TYPE: DATE:

JOB NAME & ADDRESS:

PRODUCT #:

TOTAL QUANTITY:

LAMP TYPE & WATTAGE:

TRANSFORMER:

CONTRACTOR:

SPECIFIER:

• If you are ordering LED lamps you should follow the format below:

• CL - product # - color - lamp - wattage
CL - 353 - BZ - L-EDT5 - 1.5W

Example: CL-353-BZ-L-EDT5-1.5W

• Corona Lighting reserves the right to make any change and/or improvement to the design and construction of this fixture without further notification.

ACCESSORIES SHEET

PRODUCT # : CL-353

• Step Light

• Aluminum

Cable Connector

CX-854 Direct Burial Silicone Filled Wire Nut, Tan



CX-854